

INNOSILICON

A9-ZMASTER USER MANUAL



Table of Contents

1. OVERVIEW	1
2. ASSEMBLE THE MINER	2
2.1 Check the miner before power on	2
2.2 Connect the PSU	3
3. OPERATE THE MINER	4
3.1 Enter the miner console	4
3.2 Set up the pool	4
3.3 Check the hashrate of the miner	5
3.4 Network configuration	5
3.5 Other pages	6
3.5.1 Overview	6
3.5.2 Upgrade	6
3.5.3 Modify the password	7
3.5.4 Reboot	7
3.5.5 Factory reset	7

1. OVERVIEW

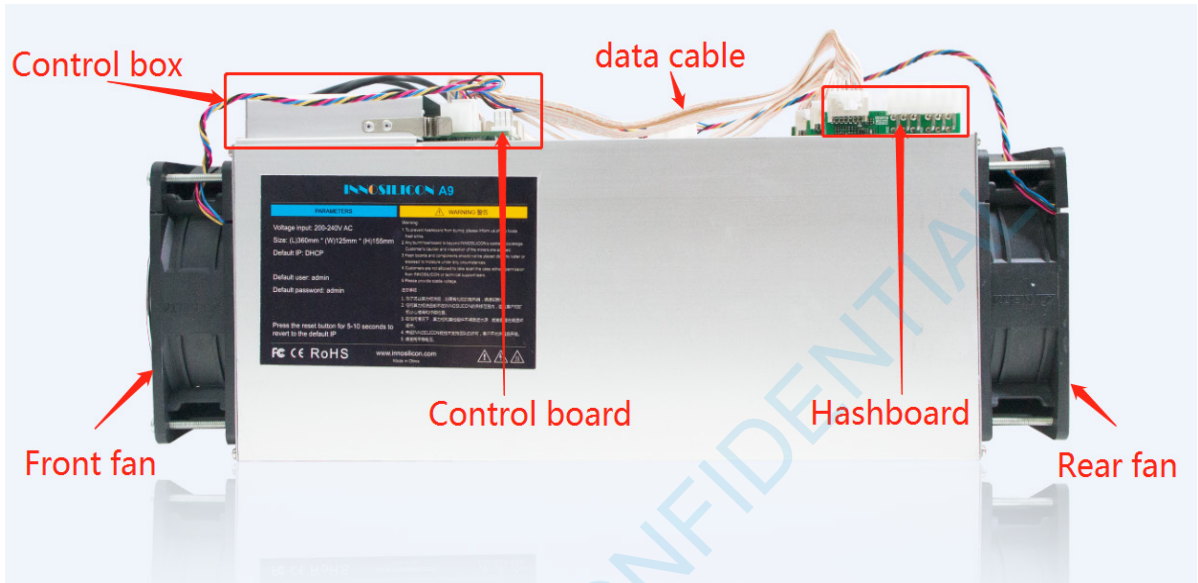

Part Number	A9
Algorithm	Equihash
Hash Rate	50Ksol/s (+-8%)
Power	620W +/-8%
Size (LxWxH)	(L)360mm*(W)125mm*(H)155mm
Net Weight	5.13KG (without PSU)
Operating Temperature	0-40 °C
Required rated PSU	1000W or above, 7 * PCI-E 6Pin
Network Connection	Ethernet

2. ASSEMBLE THE MINER

2.1 CHECK THE MINER BEFORE POWER ON

- Check the warranty sticker is well or not, especially the hashboards PSU port side. If the warranty sticker is damaged when you received the miner, please contact our After-sales.
- Before you power on the miner, shake the miner softly, if you can hear the sound of metal banging on metal, please contact our After-sales.
- Check if the fan work well, if you find the fans broken please contact our After-sales.



2.2 CONNECT THE PSU

Every hash board needs to be inserted with **2 PSU cable**, controller only needs 1 PSU cable according to the following image .

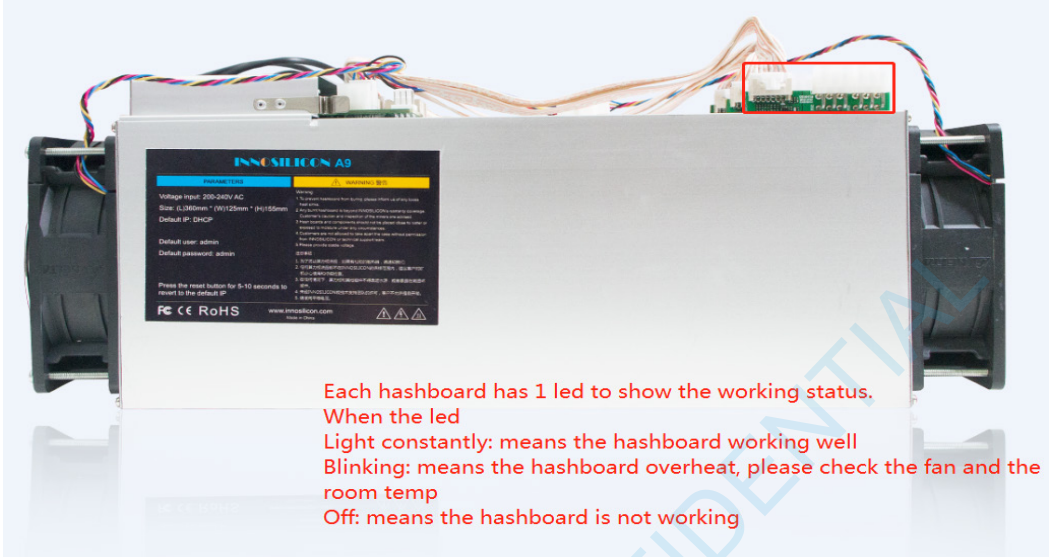

Note: Please contact out after-sales team if there is a hashboard not work.

2.3 CONNECT THE ETHERNET CABLE

Insert one end of the Ethernet cable into the router and the other end into the slot shown in the following image.

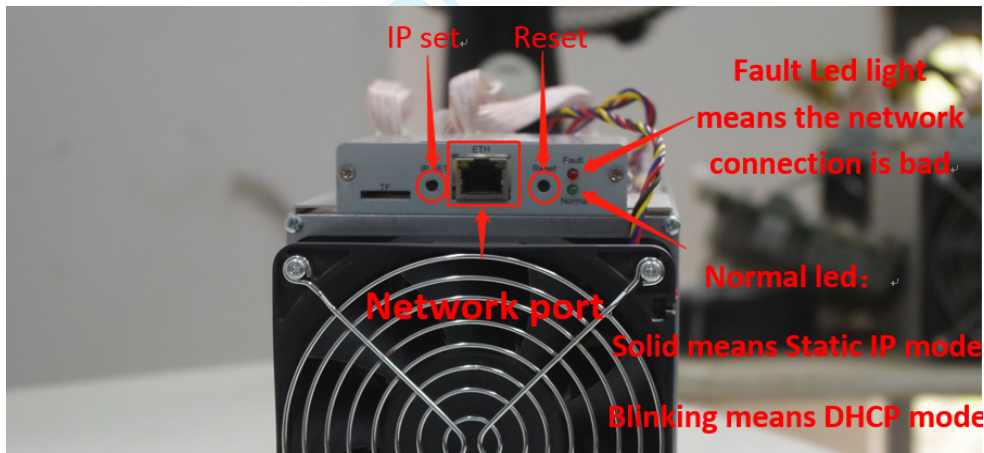

IP SET button:

Press it 1—4 seconds, it will (1) show the IP of the miner in the “Set IP” tool; (2) change the miner to Static IP mode and modify the IP to the IP range you set in the “Set IP” tool

Press it 4—15 seconds, the miner will become to DHCP and the settings of the miner should be restore to default.

Press it more than 20 seconds to switch the Dynamic (Static) IP to Static (Dynamic)

RESET button: Your miner will restart if you press it. It wont recover your settings to the default.

3. OPERATE THE MINER

3.1 ENTER THE MINER CONSOLE

DHCP(the Normal led on the control board should be blinking) is the default IP mode of the miner, find the IP via the router or the IP scanner. Enter the IP of the miner on the browser and press the Enter button. The chrome is the suggested browser.

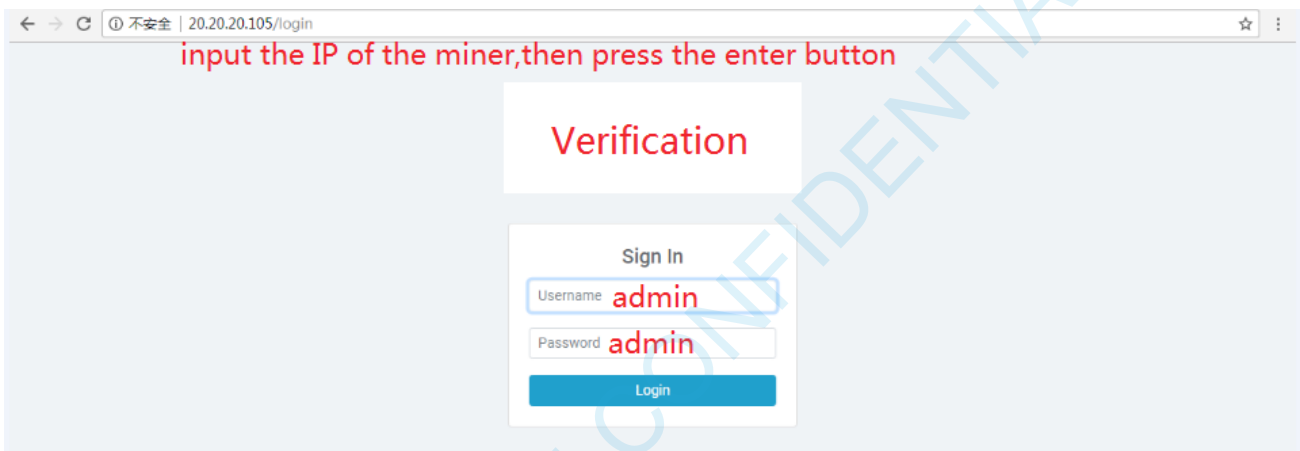

3.2 SET UP THE POOL

Note: Please don't use the Default pool.

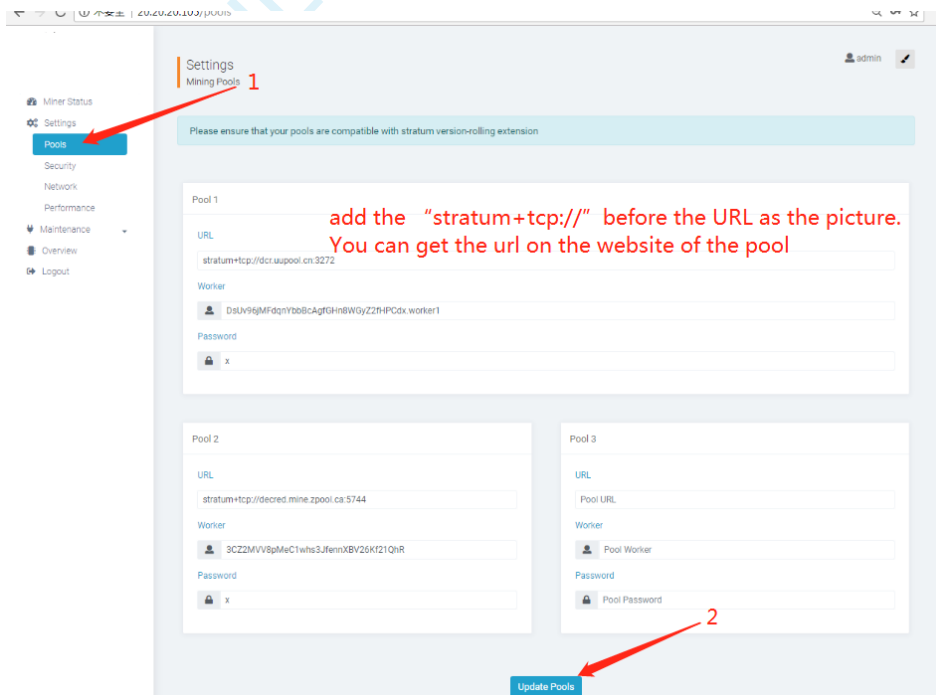

3.3 CHECK THE HASHRATE OF THE MINER

After set up the pool, the miner will mine for you.

Miner Status
Live Data (auto-refresh)

Please note the miner is autotuning, hashrate may vary until completion!

50m up time | 99.9% (1539/1) accepted rate

2.35 TH/s hash rate | 100% fan speed

hashrate graph

the using pool

#	Pool	User	Status	Get Works	Accepted / Rejected
1	stratum-tcp://dc1.uupool.cn:3272	DslUv96jMFdqYbbBcAgfGHnsWgyZ2fHPDcx.worker1	Alive	27	1539/1
2	stratum-tcp://decred.mine.zpool.ca:5744	3C2ZMVV8pMeC1whs3JfemXBV26Kf21QhR	Dead	0	0/0

hashrate of per hashboard

#	Hash Rate	Status	Accepted	Rejected	HW	Temperature
1	784.79 GH/s	Alive	474/0		3	63 °C
2	784.79 GH/s	Alive	519/1		1	63 °C
3	785.34 GH/s	Alive	546/0		5	61 °C

3.4 NETWORK CONFIGURATION

Settings
Network

if you want to use the static IP, please click here unselect the DHCP

DHCP Please check this box if you want the miner to receive an IP address automatically from your DHCP server.

IP: 20.20.20.105
Netmask: 255.255.255.0
Gateway: 20.20.20.1
DNS 1: 208.67.222.222
DNS 2: Name Server 2

1 (points to Network menu)
2 (points to Update button)

3.5 OTHER PAGES

3.5.1 OVERVIEW

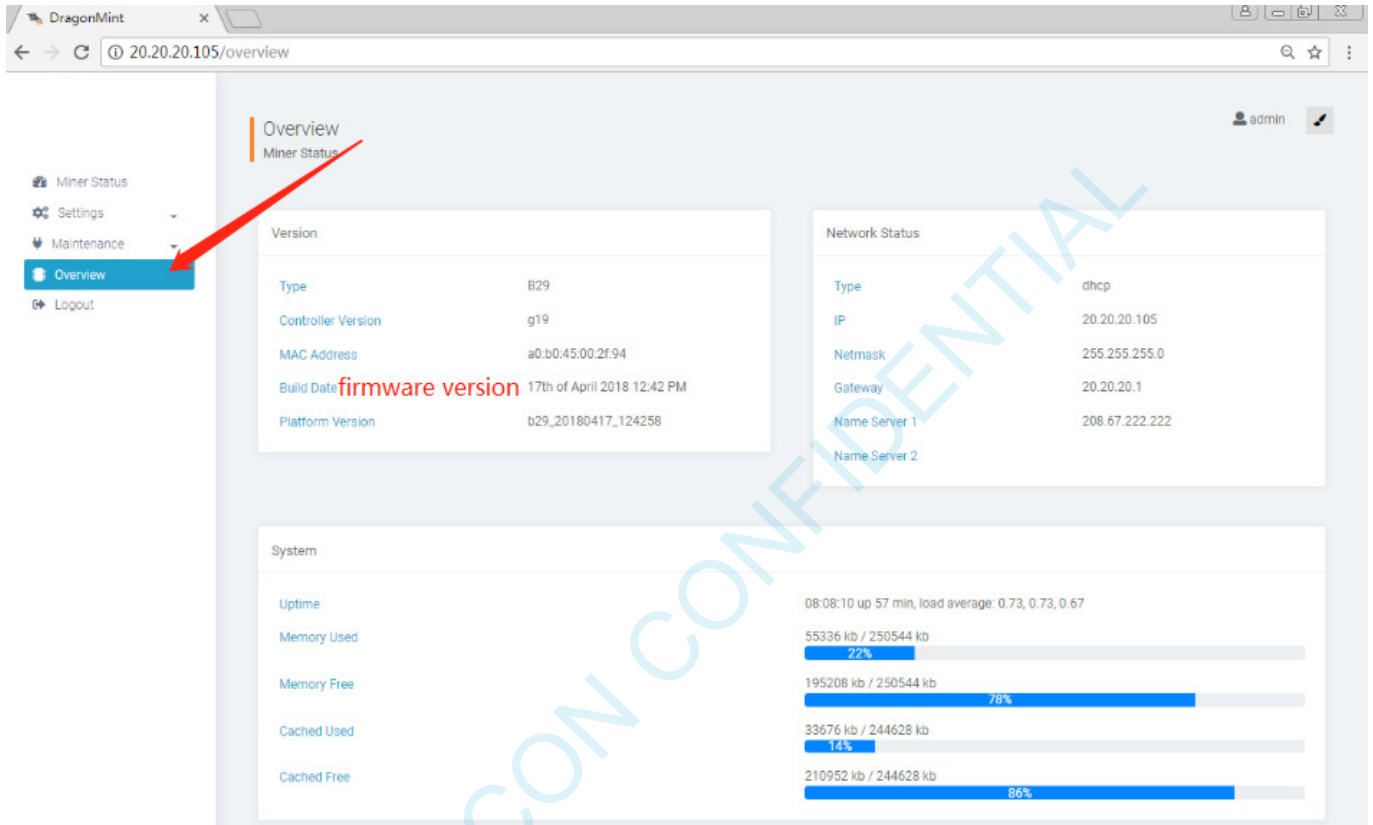

3.5.2 UPGRADE

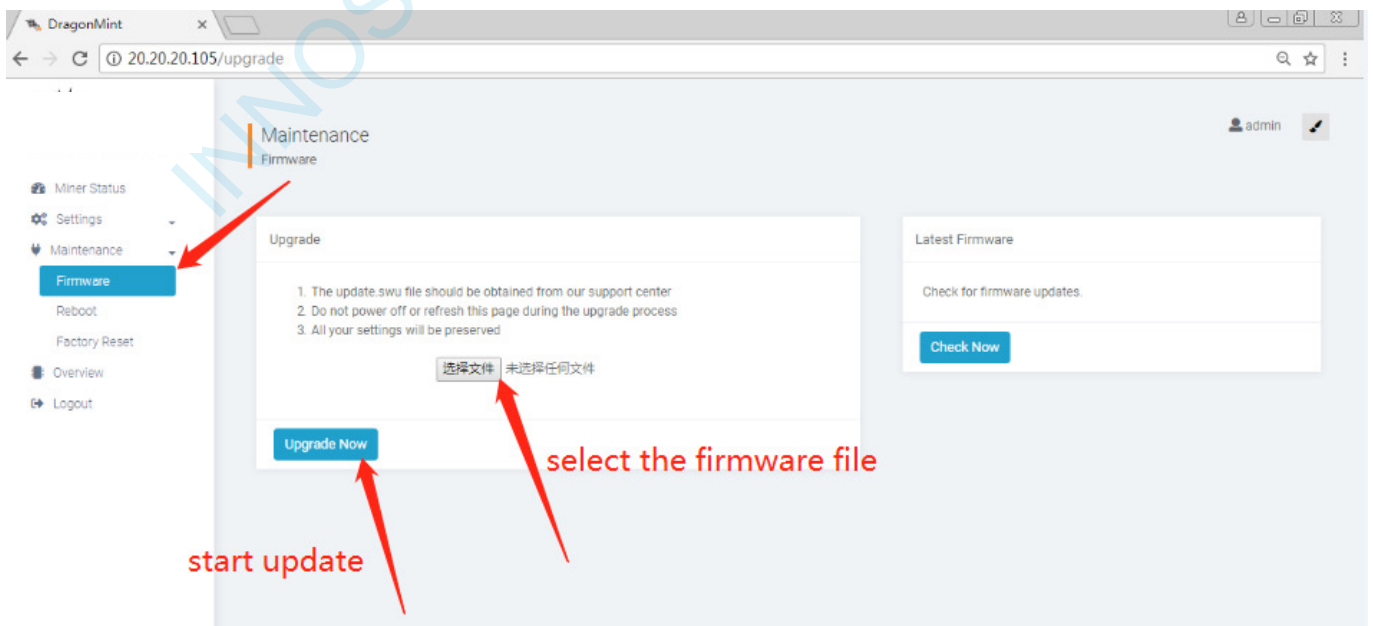

3.5.3 MODIFY THE PASSWORD

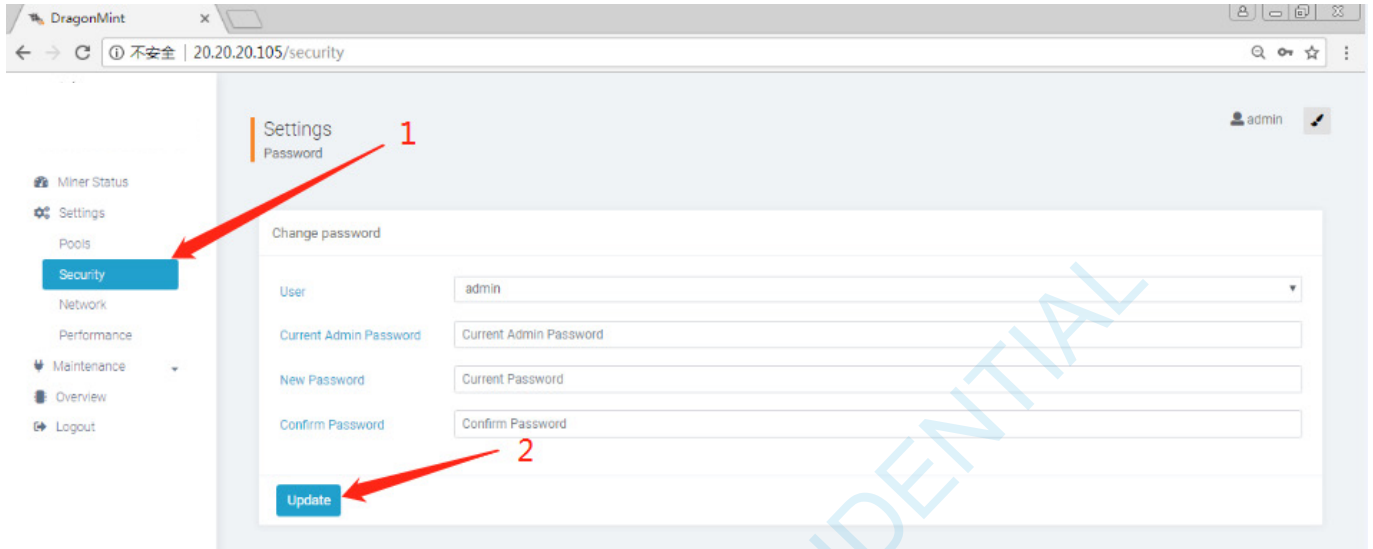

3.5.4 REBOOT

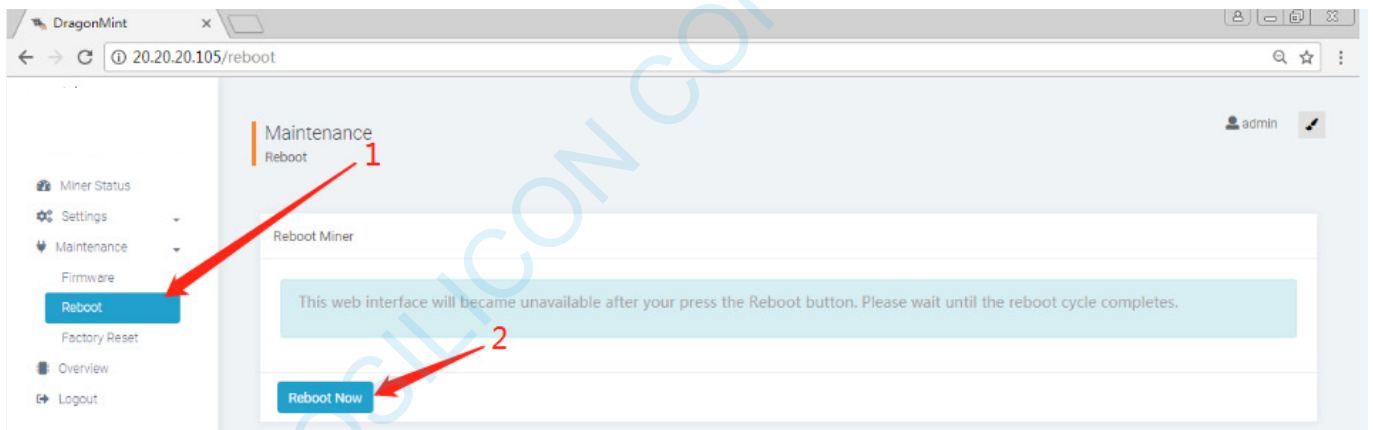

3.5.5 FACTORY RESET

